



29 South Blairbuie

Shinness, Lairg, Highland, IV27 4DN

Offers Over £120,000



UNDER OFFER

A well maintained 3 bedroom crofter's cottage that was built around 1890 and has been modernised and upgraded to include solid fuel central heating and external insulation. The property comprise on the ground floor: sitting room, kitchen and bathroom. On the first floor are three good sized bedrooms. The property sits in a large garden and has off street parking. The boundary has hedging and wire and post fencing. Amazing Scottish Highland views all around.

The village of Lairg is 6 miles east and has all local amenities. Tain is 30 miles and Tesco and Asda deliver.



HALL

Entrance to the property is a the side entrance and leads into a spacious hall where you access the sitting room, kitchen, bathroom and stairs to the three bedrooms

SITTING ROOM

The sitting room has a log burner which works the central heating and hot water. A large picture window and polished laminate flooring.

KITCHEN

A kitchen with fitted units and space for a free standing cooker, fridge/ freezer and washing machine. Window over looks the rear garden and fields beyond.

BATHROOM

A white three piece bathroom suite with overhead shower.

FIRST FLOOR

BEDROOM 1

A large bedroom with dual aspect windows and fitted carpet. Storage cupboard.

BEDROOM 2

A double bedroom with fitted wardrobe and carpet.

BEDROOM 3

The bedroom looks to the rear of the property.

ADDITIONAL INFORMATION

- Council Tax Band - A
- EPC rating -D
- Replacement windows and door approx 2018
- External Insulation added

LOCATION

PLEASE DO NOT follow the sat nav
use What3words ///pets.passes.choppers

or follow these directions ;
From Lairg head north along the A839 with the loch on your left, keep on the road past the spar, after leaving Lairg keep on the road until you see a sign saying visit shinness.... turn left and then turn right where the sign says Achnairn and Tirryside, follow this road round for about 3 km you will come to woodside campsite on your right, there isa sign here pointing right to Blairbuie. Turn right up there and follow road for a mile and you will come to 4 houses, it is the third one, the first white one.

Area Map



Floor Plans

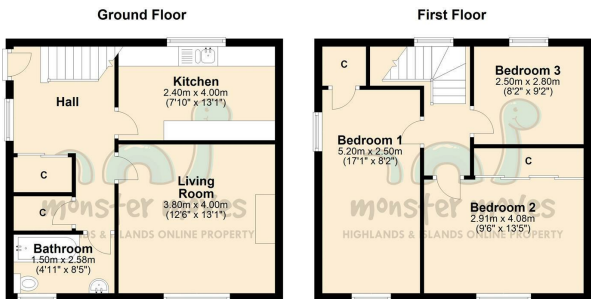

29 South Blairbuie, Shinness, Lairg

Energy Efficiency Graph

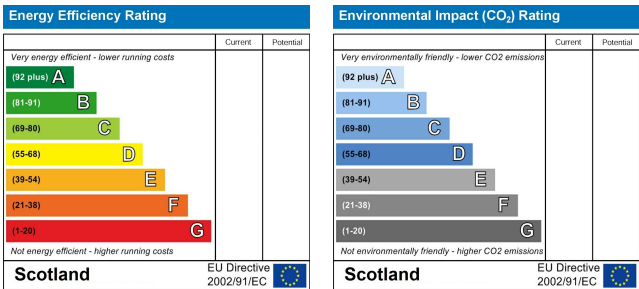





These particulars, whilst believed to be accurate are set out as a general outline only for guidance and do not constitute any part of an offer or contract. Intending purchasers should not rely on them as statements of representation of fact, but must satisfy themselves by inspection or otherwise as to their accuracy. No person in this firms employment has the authority to make or give any representation or warranty in respect of the property.